



ASTM D638 Type I Cutting Die Hardened Steel



Compression Rating: Up to 40 tons

Sample Thickness: 0-10mm – designed for plastic without reinforcing fiberglass or composite polymer

Weight: 3.7lbs.

Backing Coupling: 10mm pin (for UGC press), flat back, or 4x M8 internal screws

Notes: The Hardened Steel cutting dies are manufactured from high strength tool steel using a wire EDM machining process. The dies are then hand sharpened to a fine point and embedded into a steel frame. A compressive spring is included to aid with loading and cutting. All die measurements are within +/- 0.04mm and exceed ASTM and ISO.

Schematic (mm)

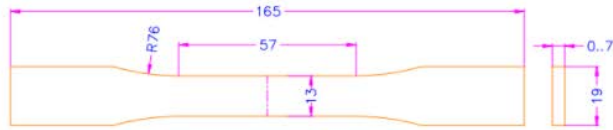

ASTM-D638-02a-Type1

