



Digital Manual Force Tester



Tensile Rating: 100lb - 1000 lbs or 2000 lbs.

Accuracy: +/- 0.5%

Travel: 5-1/2" (Longer upon request)

www.universalgripco.com

72 Loring Ave. St. 2

Salem, MA 01923

978-882-1480



Description: The Digital Force Tester features dura-lasting ACME lead screws as the travel screws and are available in capacities ranging from 100lb to 1000lbs or 2000lbs. They provide 5-1/2" of travel, with longer travel lengths available upon request. The lightweight design incorporates anodized aluminum construction with a Gauge Guard made of stainless steel for durability. The units are easy to operate and deliver +/- 0.5% accuracy, with each unit including a calibration certificate. They feature a male 5/16"-18 grip/fixture interface for convenient connection.

Schematic (in.)

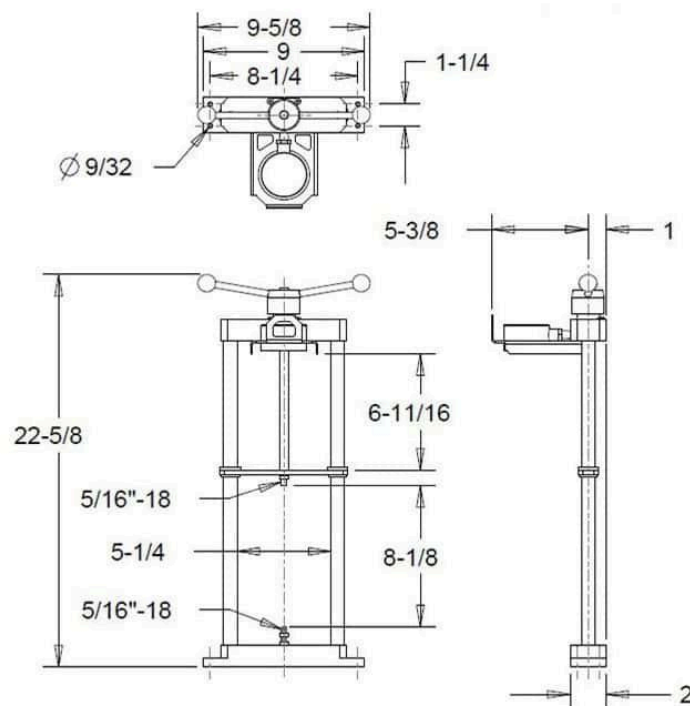

Schematic Comment: The Digital Gauge housing is bigger than the Analog Gauge's